



Phelan Community Park

Stakeholder Meeting #2 – Adventure Group

September 2020



Meeting Agenda

1. Introduction (10 min)
2. Skatepark Discussion (30 min)
3. Pump Track Discussion (30 min)
4. Closing Remarks & General Discussion (20 min)

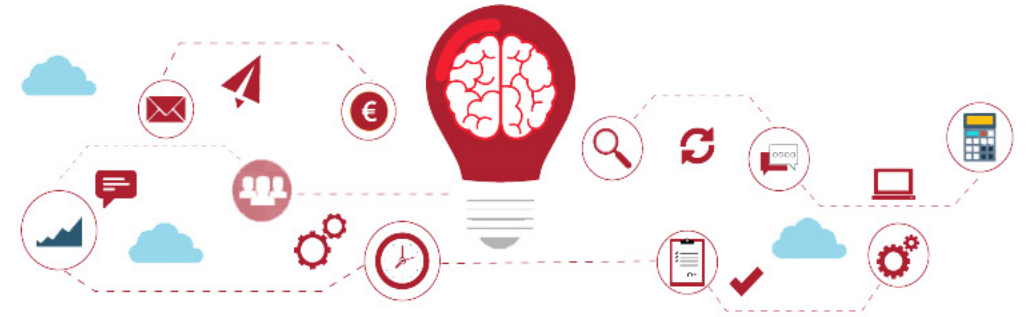



1

INTRODUCTION

Introductions

- Please share your name and affiliation
- What is your recreational focus (i.e., skate boarding, BMX / bike, in-line, scooter, etc.)?
- Are you a resident of Phelan?
- Age range?

Project Overview & Background

- Phelan / Piñon Hills community wide Parks Master Plan completed in 2018.
- Phelan / Piñon Hills Community Services District (PPHCSD) recently purchased land for expansion of the existing community park and for a civic center.
- Hired project architect and engineer for civic center site. Added KTUA for assistance on civic center and to consult on design for community park in May 2020.



Prop 68 Grant Funding

- Last round of the statewide Prop 68 grants (around 400 million dedicated to parks throughout California)
- Park qualifies for this grant given the lack of parkland in the area
- Considering this is an expansion of parkland, we don't get the full points for a new park
- Major selection criteria includes
 - Project Location
 - Community Engagement
 - Operation and Maintenance Considerations
 - Summary About Project Needs, Benefits, & Readiness

| PROJECT SELECTION CRITERIA | | MAX POINT VALUE |
|--|--|-----------------|
| PROJECT LOCATION | | |
| 1. | Critical Lack of PARK SPACE | 15 |
| 2. | Significant Poverty | 16 |
| 3. | Type of Project | 10 |
| COMMUNITY ENGAGEMENT | | |
| 4. | Community Based Planning | 18 |
| 5. | Employment or Volunteer Opportunities | 6 |
| 6. | Partnerships or Committed Funding | 3 |
| OPERATION AND MAINTENANCE CONSIDERATIONS | | |
| 7. | Environmental Design | 7 |
| 8. | Public Use Fees and Hours of Operation | 5 |
| SUMMARY ABOUT PROJECT NEED, BENEFITS, AND READINESS | | |
| 9. | Community CHALLENGES, Project Benefits and Readiness | 20 |
| MAXIMUM SCORE | | 100 |

PPHCSD Master Plan Survey | Importance of Facilities

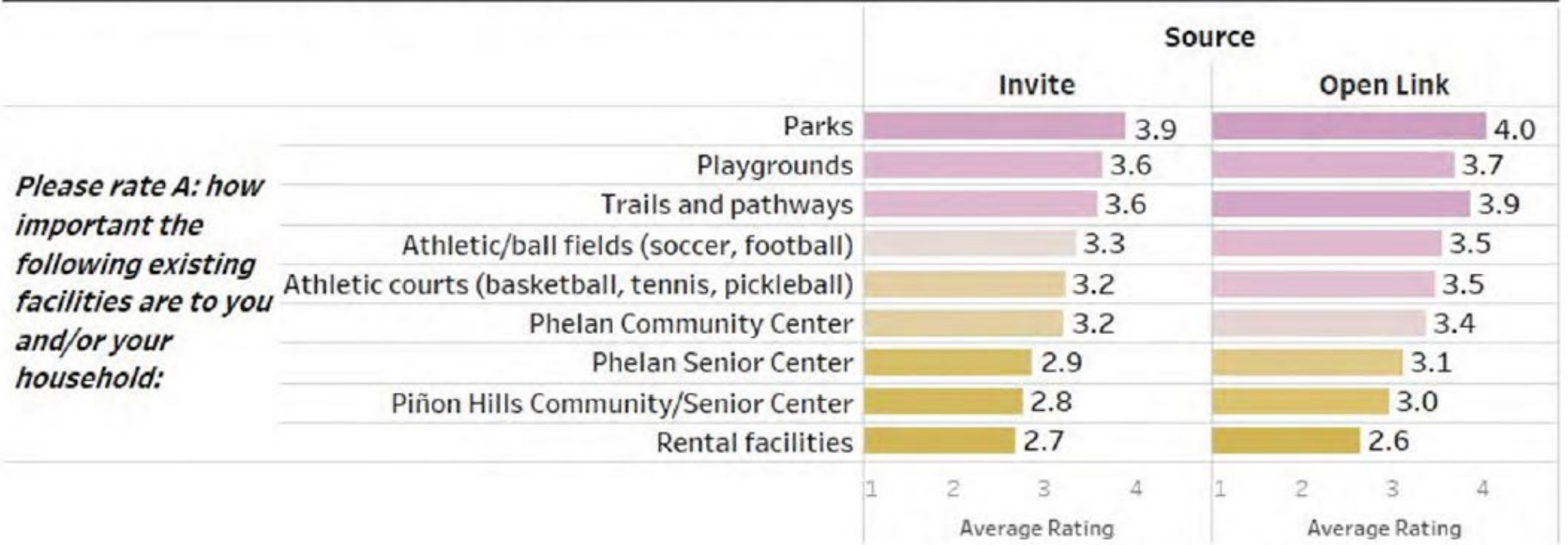

Source: RRC Associates and GreenPlay

PPHCSD Master Plan Survey | Future Facilities and Programs

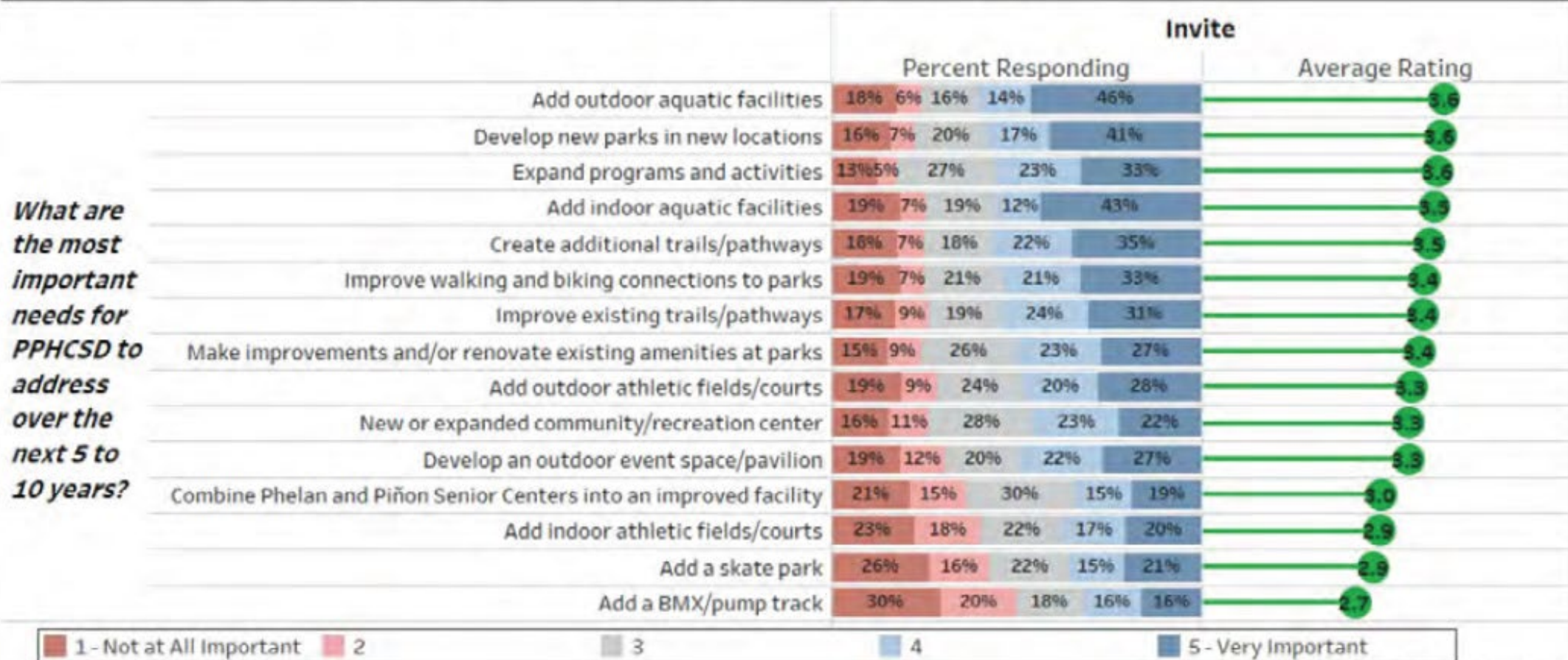

Source: RRC Associates and GreenPlay

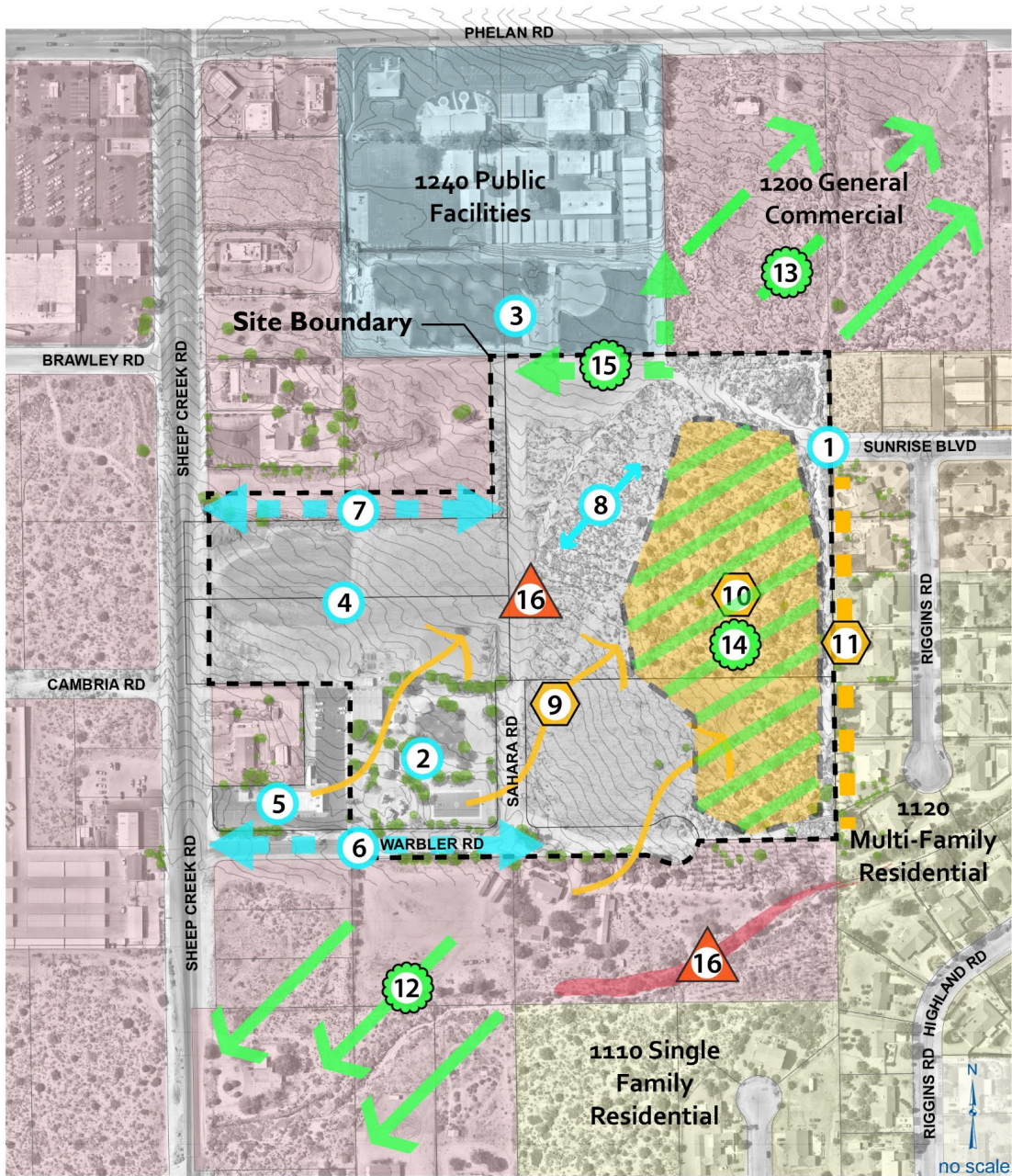

Opportunities

1. Connection to neighborhood
2. Existing park with infrastructure to use and connect into park
3. Possible future connections to elementary school
4. Flat/Graded area that connects to Sheep Creek Rd.
5. Connection to existing community center
6. Connections through Warbler Rd.
7. Possible connections from Sheep Creek Rd.
8. Gentle slope on site which could be used for views and to allow for directional drainage

Constraints

9. Strong winds from the southwest
10. Joshua Tree grove (speciman plants - over 10 in one area)
11. Adjacent homes along this edge requiring a buffer

Assets

12. Views to mountains
13. Views to valley
14. Existing native vegetation
15. Circulation outside of site from existing elementary school parking lot

Liabilities

16. 100 Year floodplain, improper drainage (flash floods) and possible poor soil conditions

Definitions for L.O.C.A.L. elements:

- Opportunity: Something that does not currently exist but an opportunity to add based on site conditions does exist.
- Constraint: Something that exists but can't be changed.
- Asset: Something that exists that should be protected or enhanced.
- Liability: A condition on site that is negative and should be changed.



PHELAN COMMUNITY PARK

PROGRAMMATIC
STUDIES

SELECTED
CONCEPT

BRAWLEY ROAD

SHEEP CREEK ROAD

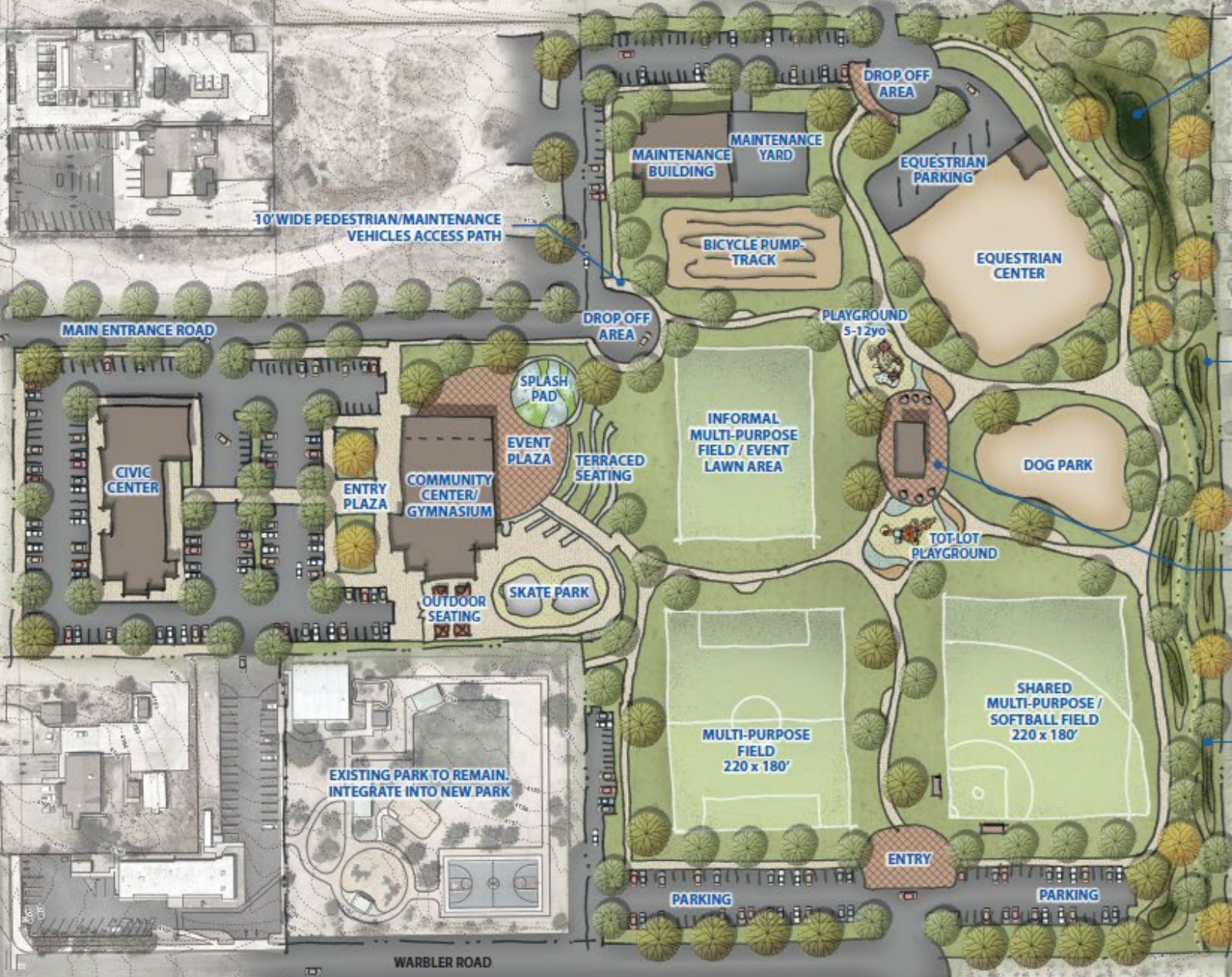

MAIN ENTRANCE ROAD

10' WIDE PEDESTRIAN/MAINTENANCE VEHICLES ACCESS PATH

DROP OFF AREA

MAINTENANCE BUILDING

MAINTENANCE YARD

DROP OFF AREA

BICYCLE PUMP TRACK

EQUESTRIAN PARKING

EQUESTRIAN CENTER

PLAYGROUND 5-12yo

SPLASH PAD

EVENT PLAZA

TERRACED SEATING

INFORMAL MULTI-PURPOSE FIELD / EVENT LAWN AREA

DOG PARK

TOT LOT PLAYGROUND

CIVIC CENTER

ENTRY PLAZA

COMMUNITY CENTER/GYMNASIUM

OUTDOOR SEATING

SKATE PARK

EXISTING PARK TO REMAIN. INTEGRATE INTO NEW PARK

MULTI-PURPOSE FIELD 220 x 180'

SHARED MULTI-PURPOSE / SOFTBALL FIELD 220 x 180'

ENTRY

PARKING

PARKING

WARBLER ROAD

DETENTION BASIN/ NATURAL EDUCATION

SUNRISE BLVD

BUFFER AREA WITH TRAILS AND NATIVE VEGETATION

CENTRAL PLAZA WITH RESTROOM, CONCESSION

STREAM COURSE FOR FLOODWATER AND DRAINAGE USING A DRY CREEKBED

BRAWLEY ROAD

SHEEP CREEK ROAD

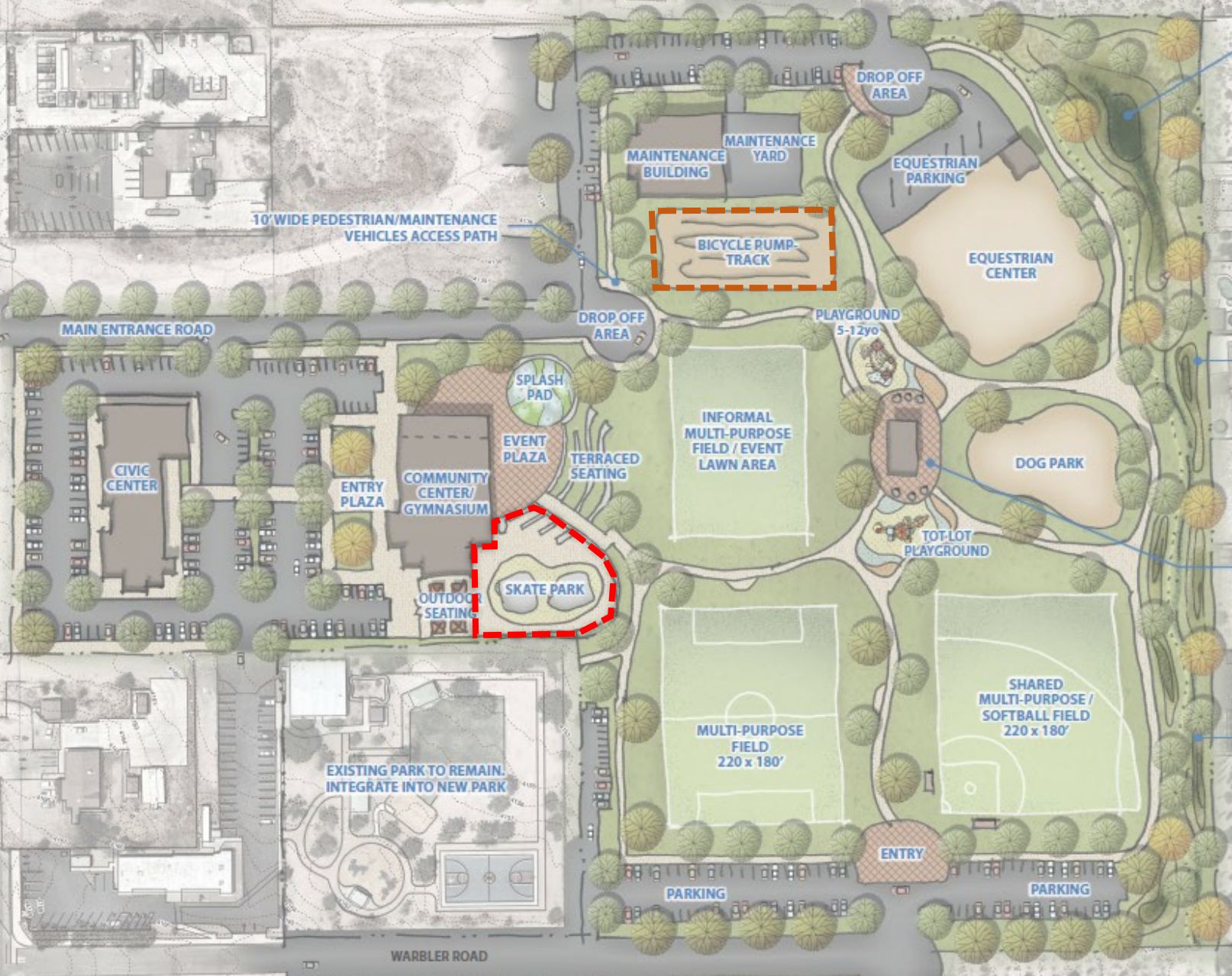

DETENTION BASIN/
NATURAL EDUCATION

SUNRISE BLVD

BUFFER AREA WITH
TRAILS AND NATIVE
VEGETATION

CENTRAL PLAZA WITH
RESTROOM, CONCESSION

STREAM COURSE FOR
FLOODWATER AND
DRAINAGE USING A DRY
CREEKBED

10' WIDE PEDESTRIAN/MAINTENANCE
VEHICLES ACCESS PATH

MAIN ENTRANCE ROAD

DROP OFF AREA

DROP OFF AREA

MAINTENANCE
BUILDING

MAINTENANCE
YARD

EQUESTRIAN
PARKING

EQUESTRIAN
CENTER

BICYCLE PUMP
TRACK

PLAYGROUND
5-12yo

INFORMAL
MULTI-PURPOSE
FIELD / EVENT
LAWN AREA

DOG PARK

TOT LOT
PLAYGROUND

EVENT
PLAZA

TERRACED
SEATING

COMMUNITY
CENTER/
GYMNASIUM

ENTRY
PLAZA

CIVIC
CENTER

SKATE
PARK

OUTDOOR
SEATING

EXISTING PARK TO REMAIN.
INTEGRATE INTO NEW PARK

MULTI-PURPOSE
FIELD
220 x 180'

SHARED
MULTI-PURPOSE /
SOFTBALL FIELD
220 x 180'

ENTRY

PARKING

PARKING

WARBLER ROAD

A person wearing a colorful, patterned t-shirt and khaki pants is riding a skateboard in a skatepark. The park features various concrete structures, including ramps, rails, and ledges. Other people are visible in the background, some also on skateboards. The scene is set outdoors with trees and a clear sky in the distance.

2

SKATEPARK

Area Overview

- Approx. 16K Sq. Ft. (area in red) / 8K Sq. Ft. (area in blue)
- Located at western side of site near the community center / gymnasium

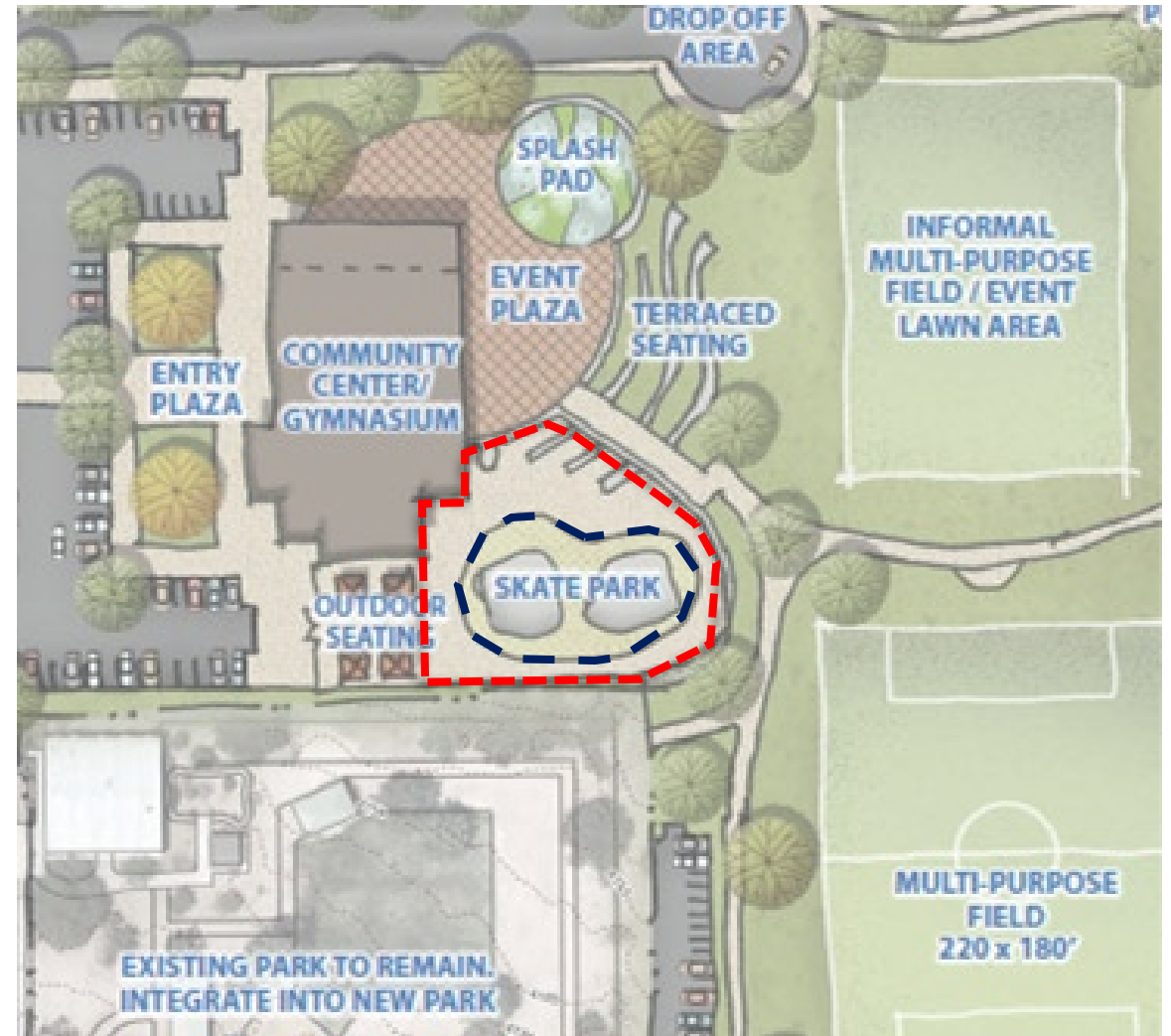



PHELAN COMMUNITY PARK

SKATEPARK IMAGES

Questions

What style of terrain do you prefer (i.e., street or bowl/s)?

Questions

How long have you been participating and/or what is your skill level?

Questions

What skill level do you anticipate most skatepark users being within the community?

An aerial view of a pump track, a type of bicycle track. The track is composed of grey asphalt with green grass sections. The track features several large, rounded mounds and dips, connected by narrow paths. A white pickup truck is parked on the left side of the track, and several people are standing nearby. The background shows a grassy area with trees and a building.

3

PUMP TRACK

Area Overview

- Approx. 17.5K Sq. Ft.
- Located at the end of the entrance road near the maintenance building

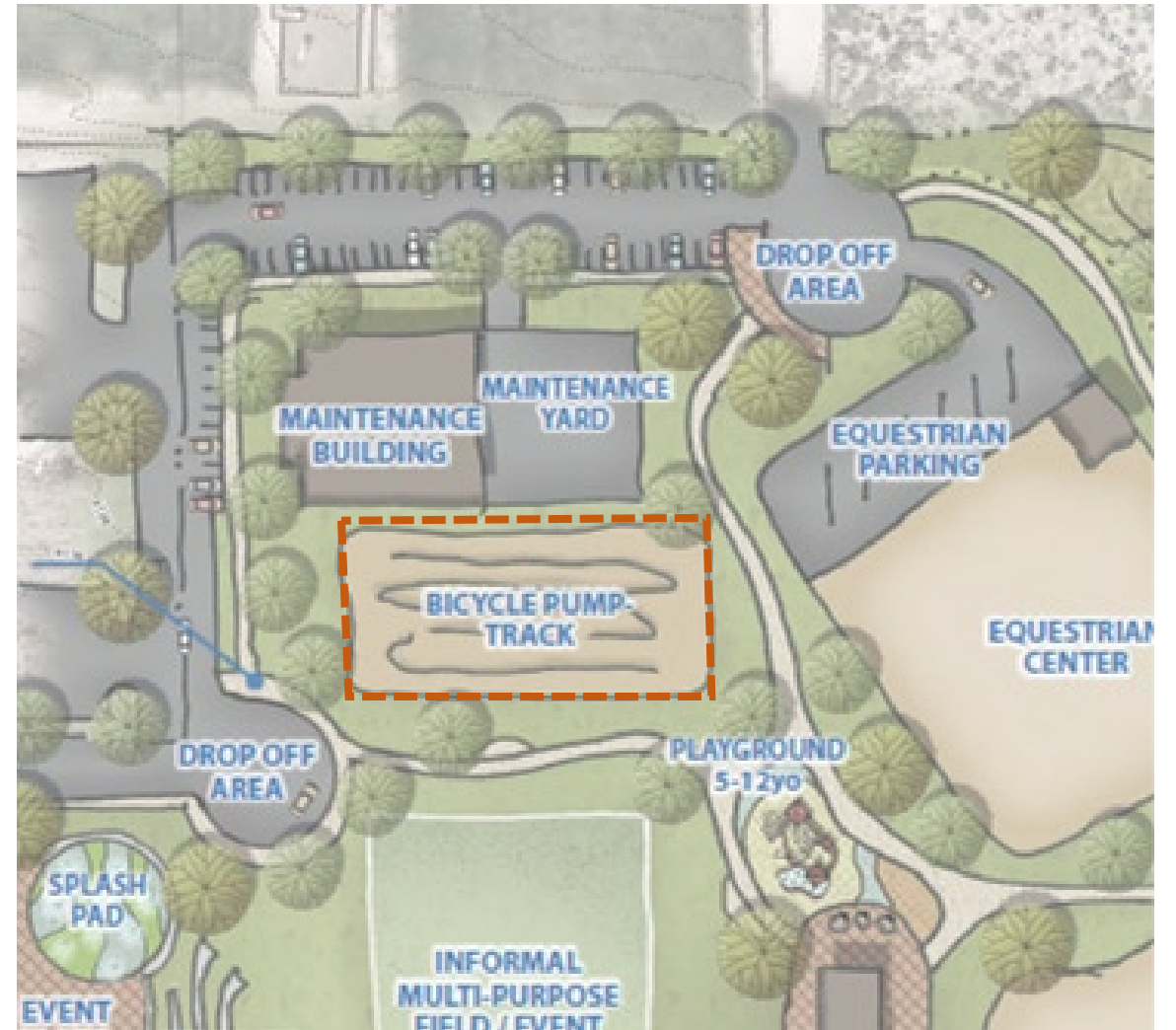



PHELAN COMMUNITY PARK

PUMP TRACK IMAGES

Questions

What style of terrain do you prefer (i.e, continuous loop, race style – start/finish, etc.)?

Questions

What surface types do you prefer (i.e., dirt or asphalt/concrete)?

Questions

How long have you been participating and/or what is your skill level?

Questions

What skill level do you anticipate most pump track users being within the community





4

**CLOSING REMARKS
AND GENERAL
DISCUSSION**

Online Survey

2. Adventure Sports

Please indicate your priority, however, please do not select the same priority for all.

| | Low | Medium | High |
|---|-----------------------|-----------------------|-----------------------|
| Pump Track (bmx / mtn. bike circular track)  | <input type="radio"/> | <input type="radio"/> | <input type="radio"/> |
| Skatepark  | <input type="radio"/> | <input type="radio"/> | <input type="radio"/> |
| Playground 2-5 years old  | <input type="radio"/> | <input type="radio"/> | <input type="radio"/> |
| Playground 5-12 years old  | <input type="radio"/> | <input type="radio"/> | <input type="radio"/> |

Next Steps – Team Schedule

- Community Workshop #1
- Community Stakeholder Meetings
- Community Workshop #2
 - Final Program Summary
 - Pre-Final Site Plan
 - Area Enlargements
- Community Workshop #3
 - Final Materials & Amenities
 - Cost Prioritization & Phasing
 - Prop 68 Areas / Facilities
- Community Workshop #4 / Board Hearing

| PROJECT SCHEDULE | | AUG | | | | SEP | | | | OCT | | | | NOV | | | | DEC | | | | JAN | | FEB | | |
|---|--|------|----|----|----|-----|----|----|----|-----|----|----|----|-----|---|----|----|-----|---|----|----|------|--|-----|--|--|
| PHELAN COMMUNITY PARK SCHEMATIC DESIGN | | 10 | 17 | 24 | 31 | 7 | 14 | 21 | 28 | 5 | 12 | 19 | 26 | 2 | 9 | 16 | 23 | 30 | 7 | 14 | 21 | 28 | | | | |
| UPDATED - 08/11/2020 | | 2020 | | | | | | | | | | | | | | | | | | | | 2021 | | | | |
| AREA A: 14-ACRE PARK | | | | | | | | | | | | | | | | | | | | | | | | | | |
| TASK GROUP A: KICK-OFF & COMMUNITY OUTREACH | | | | | | | | | | | | | | | | | | | | | | | | | | |
| 1.1 Kick Off Meeting | | | | | | | | | | | | | | | | | | | | | | | | | | |
| 1.2A Digital Community Workshop #1 | | | | | | | | | | | | | | | | | | | | | | | | | | |
| 1.2B Digital Community Workshop #2 | | | | | | | | | | | | | | | | | | | | | | | | | | |
| 1.3A Stakeholder Interest Group Meeting #1 | | | | | | | | | | | | | | | | | | | | | | | | | | |
| 1.3B Stakeholder Interest Group Meeting #2 | | | | | | | | | | | | | | | | | | | | | | | | | | |
| 1.3C Stakeholder Interest Group Meeting #3 | | | | | | | | | | | | | | | | | | | | | | | | | | |
| TASK GROUP B: DRAFT SCHEMATIC DESIGN PACKAGE (15%) | | | | | | | | | | | | | | | | | | | | | | | | | | |
| 1.4 Final Programming | | | | | | | | | | | | | | | | | | | | | | | | | | |
| 1.5-1.11 Schematic Design 14 Acre Park | | | | | | | | | | | | | | | | | | | | | | | | | | |
| 1.12 Draft Package for Initial CUP Conformance | | | | | | | | | | | | | | | | | | | | | | | | | | |
| 1.13 Draft Construction Estimate (with 25% contingency) | | | | | | | | | | | | | | | | | | | | | | | | | | |
| 1.14: 3D Model & Perspectives (4 total) | | | | | | | | | | | | | | | | | | | | | | | | | | |
| TASK GROUP D: REFINED MASTER PLAN & WORKSHOPS #3 & 4 | | | | | | | | | | | | | | | | | | | | | | | | | | |
| 2.1 Refined Master Plan | | | | | | | | | | | | | | | | | | | | | | | | | | |
| 2.2A Digital Community Workshop #3 | | | | | | | | | | | | | | | | | | | | | | | | | | |
| 2.2B Digital Community Workshop #4 / Board Hearing | | | | | | | | | | | | | | | | | | | | | | | | | | |
| TASK GROUP E: FINAL SCHEMATIC PACKAGE (35%) | | | | | | | | | | | | | | | | | | | | | | | | | | |
| 2.3 - 2.11: Final Schematic Design, 14 Acre Park | | | | | | | | | | | | | | | | | | | | | | | | | | |
| 2.12: Construction Estimate (with 25% contingency) | | | | | | | | | | | | | | | | | | | | | | | | | | |
| 2.13: Outline Specifications | | | | | | | | | | | | | | | | | | | | | | | | | | |
| 2.14: CD Sheet / Package Layout & Numbering | | | | | | | | | | | | | | | | | | | | | | | | | | |
| 2.15: Revised 3D Model and Perspectives (4 total) | | | | | | | | | | | | | | | | | | | | | | | | | | |
| TASK GROUP F: FINAL CUP PACKAGE | | | | | | | | | | | | | | | | | | | | | | | | | | |
| 2.16: CUP Package for 14-acre park (architect to process) | | | | | | | | | | | | | | | | | | | | | | | | | | |

Questions & Comments