

Phelan Community Park

Stakeholder Meeting #1

September 2020



ktua

Meeting Agenda

1. Introduction (10 min)
2. Equestrian Facility Discussion (20 min)
3. Dog Park Discussion (20 min)
4. Community Garden Discussion (20 min)
5. Closing Remarks & General Discussion (20 min)





1

INTRODUCTION

Project Overview & Background

- Phelan / Piñon Hills community wide Parks Master Plan completed in 2018.
- Phelan / Piñon Hills Community Services District (PPHCSD) recently purchased land for expansion of the existing community park and for a civic center.
- Hired project architect and engineer for civic center site. Added KTUA for assistance on civic center and to consult on design for community park in May 2020.



Prop 68 Grant Funding

- Last round of the statewide Prop 68 grants (around 400 million dedicated to parks throughout California)
- Park qualifies for this grant given the lack of parkland in the area
- Considering this is an expansion of parkland, we don't get the full points for a new park
- Major selection criteria includes
 - Project Location
 - Community Engagement
 - Operation and Maintenance Considerations
 - Summary About Project Needs, Benefits, & Readiness

PROJECT SELECTION CRITERIA		MAX POINT VALUE
PROJECT LOCATION		
1.	Critical Lack of PARK SPACE	15
2.	Significant Poverty	16
3.	Type of Project	10
COMMUNITY ENGAGEMENT		
4.	Community Based Planning	18
5.	Employment or Volunteer Opportunities	6
6.	Partnerships or Committed Funding	3
OPERATION AND MAINTENANCE CONSIDERATIONS		
7.	Environmental Design	7
8.	Public Use Fees and Hours of Operation	5
SUMMARY ABOUT PROJECT NEED, BENEFITS, AND READINESS		
9.	Community CHALLENGES, Project Benefits and Readiness	20
MAXIMUM SCORE		100

PPHCSD Master Plan Survey | Importance of Facilities

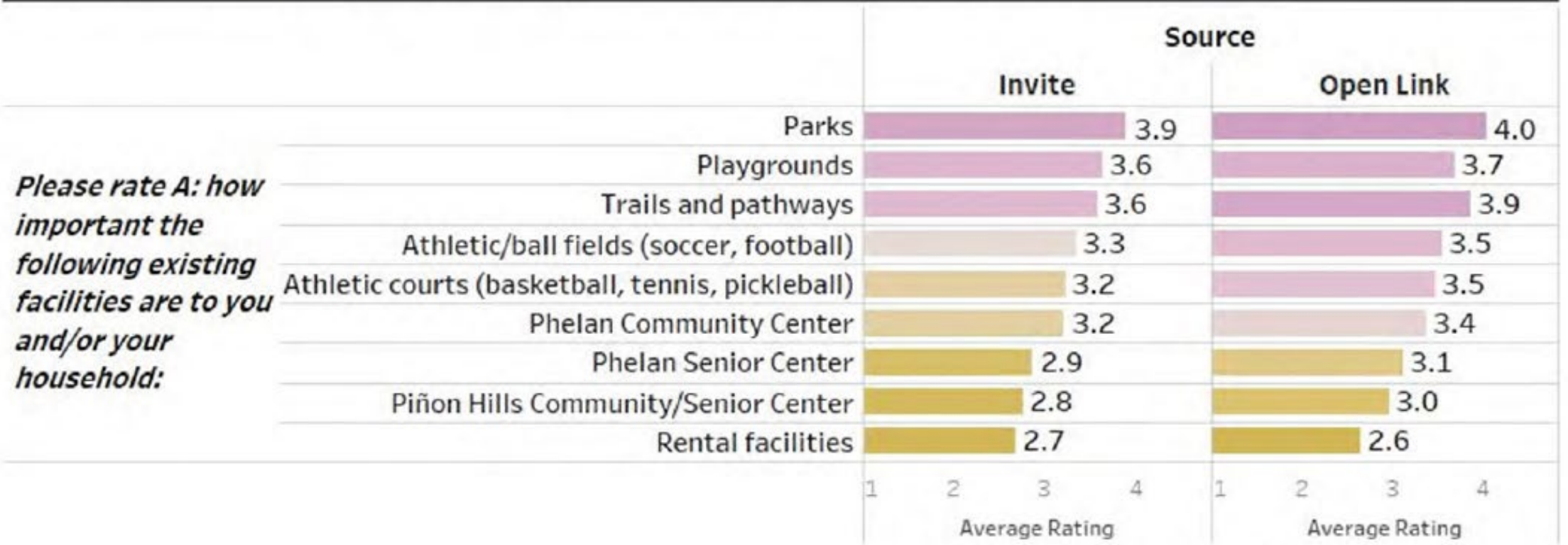

Source: RRC Associates and GreenPlay

PPHCSD Master Plan Survey | Future Facilities and Programs

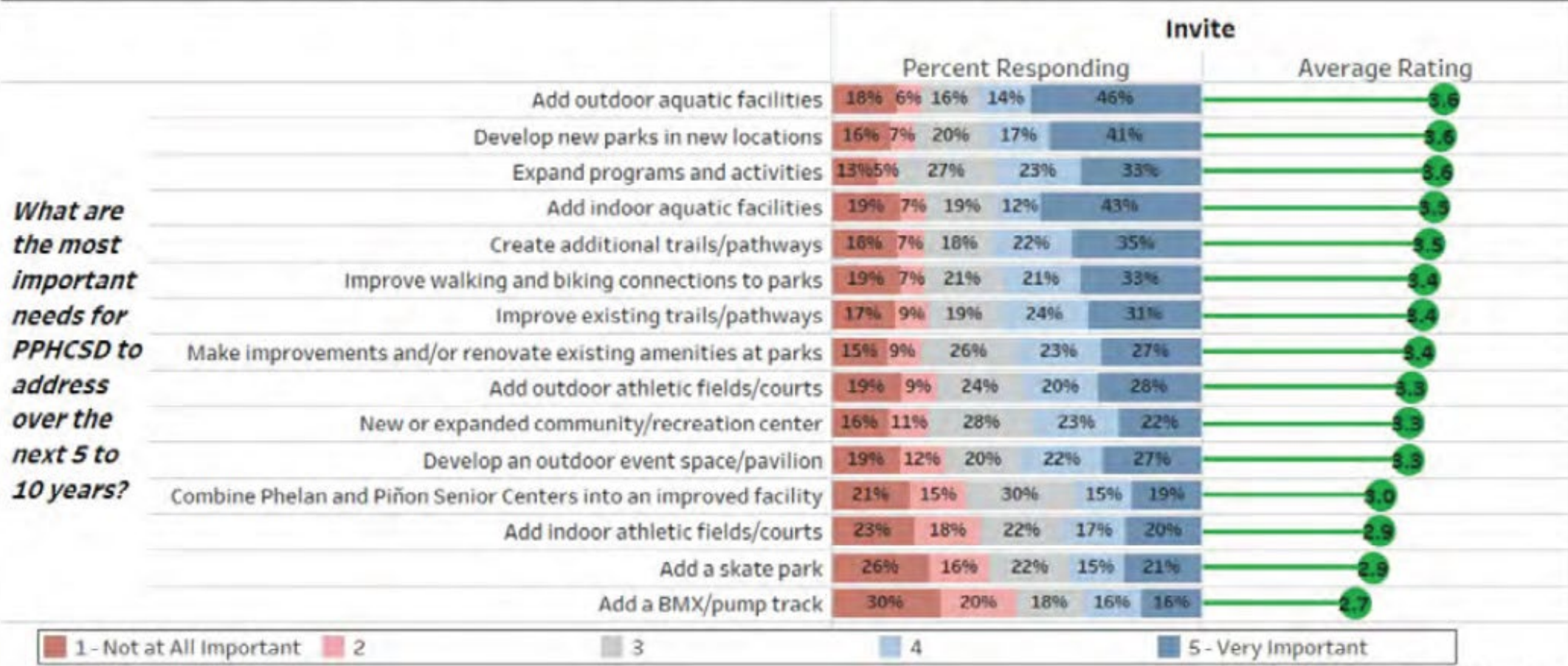

Source: RRC Associates and GreenPlay

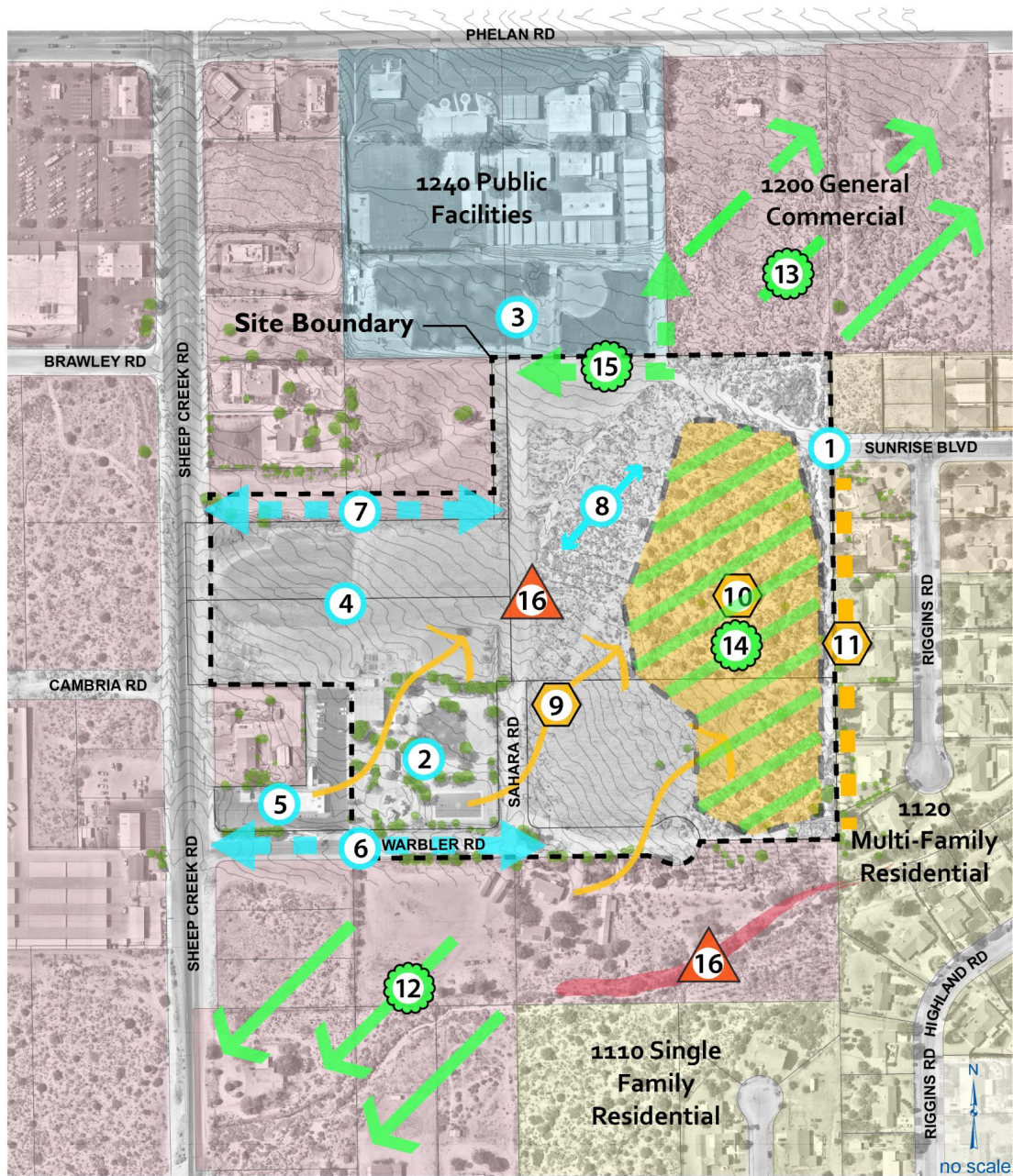

Opportunities

1. Connection to neighborhood
2. Existing park with infrastructure to use and connect into park
3. Possible future connections to elementary school
4. Flat/Graded area that connects to Sheep Creek Rd.
5. Connection to existing community center
6. Connections through Warbler Rd.
7. Possible connections from Sheep Creek Rd.
8. Gentle slope on site which could be used for views and to allow for directional drainage

Constraints

9. Strong winds from the southwest
10. Joshua Tree grove (speciman plants - over 10 in one area)
11. Adjacent homes along this edge requiring a buffer

Assets

12. Views to mountains
13. Views to valley
14. Existing native vegetation
15. Circulation outside of site from existing elementary school parking lot

Liabilities

16. 100 Year floodplain, improper drainage (flash floods) and possible poor soil conditions

Definitions for L.O.C.A.L. elements:

- Opportunity: Something that does not currently exist but an opportunity to add based on site conditions does exist.
- Constraint: Something that exists but can't be changed.
- Asset: Something that exists that should be protected or enhanced.
- Liability: A condition on site that is negative and should be changed.



PHELAN COMMUNITY PARK

PROGRAMMATIC
STUDIES

SELECTED
CONCEPT

BRAWLEY ROAD

SHEEP CREEK ROAD

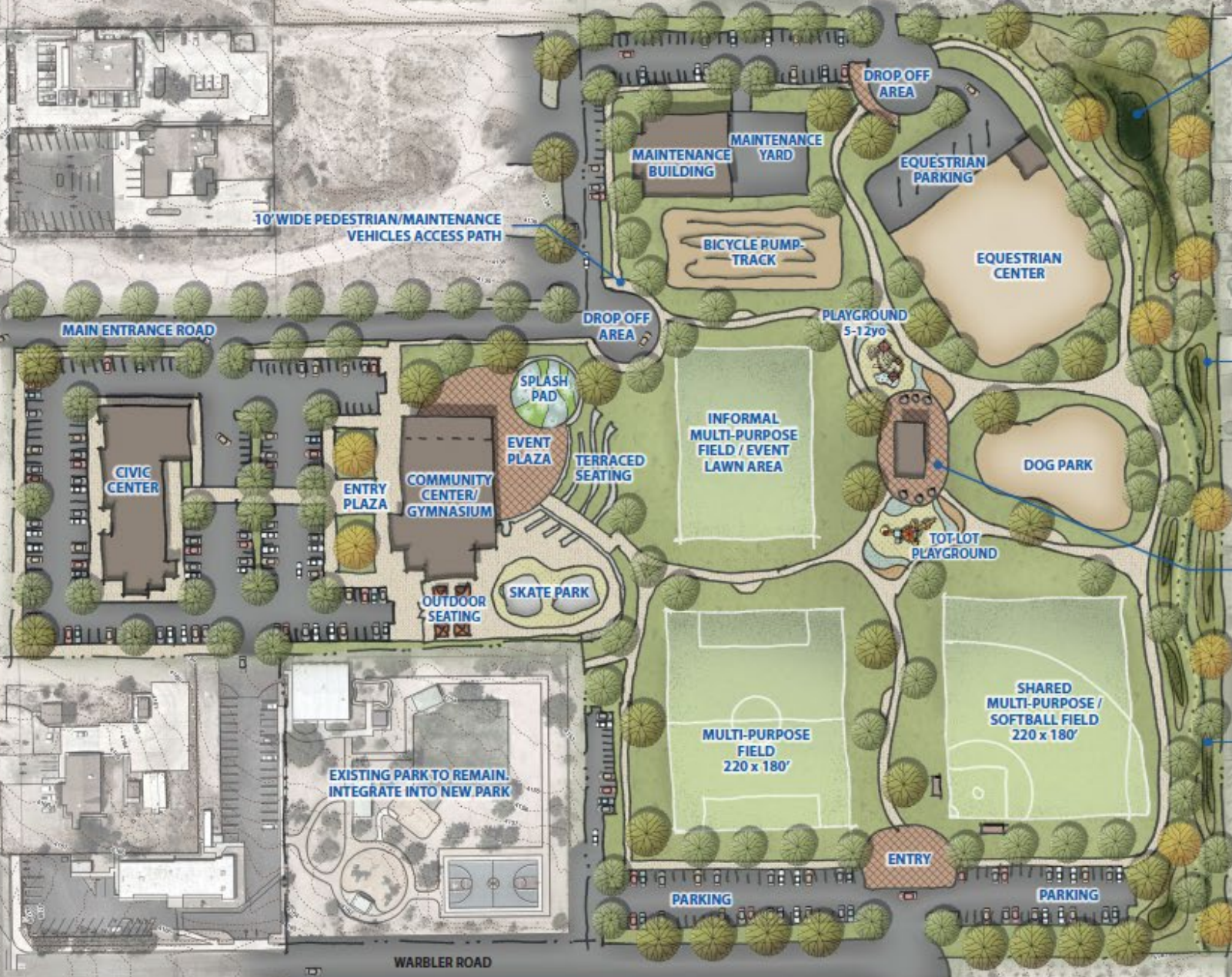

10' WIDE PEDESTRIAN/MAINTENANCE VEHICLES ACCESS PATH

MAIN ENTRANCE ROAD

DROP OFF AREA

DROP OFF AREA

MAINTENANCE BUILDING

MAINTENANCE YARD

BICYCLE PUMP TRACK

EQUESTRIAN PARKING

EQUESTRIAN CENTER

PLAYGROUND 5-12yo

SPLASH PAD

EVENT PLAZA

TERRACED SEATING

INFORMAL MULTI-PURPOSE FIELD / EVENT LAWN AREA

DOG PARK

CIVIC CENTER

ENTRY PLAZA

COMMUNITY CENTER / GYMNASIUM

OUTDOOR SEATING

SKATE PARK

TOT LOT PLAYGROUND

MULTI-PURPOSE FIELD 220 x 180'

SHARED MULTI-PURPOSE / SOFTBALL FIELD 220 x 180'

ENTRY

PARKING

PARKING

EXISTING PARK TO REMAIN. INTEGRATE INTO NEW PARK

WARBLER ROAD

DETENTION BASIN/ NATURAL EDUCATION

SUNRISE BLVD

BUFFER AREA WITH TRAILS AND NATIVE VEGETATION

CENTRAL PLAZA WITH RESTROOM, CONCESSION

STREAM COURSE FOR FLOODWATER AND DRAINAGE USING A DRY CREEKBED

BRAWLEY ROAD

SHEEP CREEK ROAD

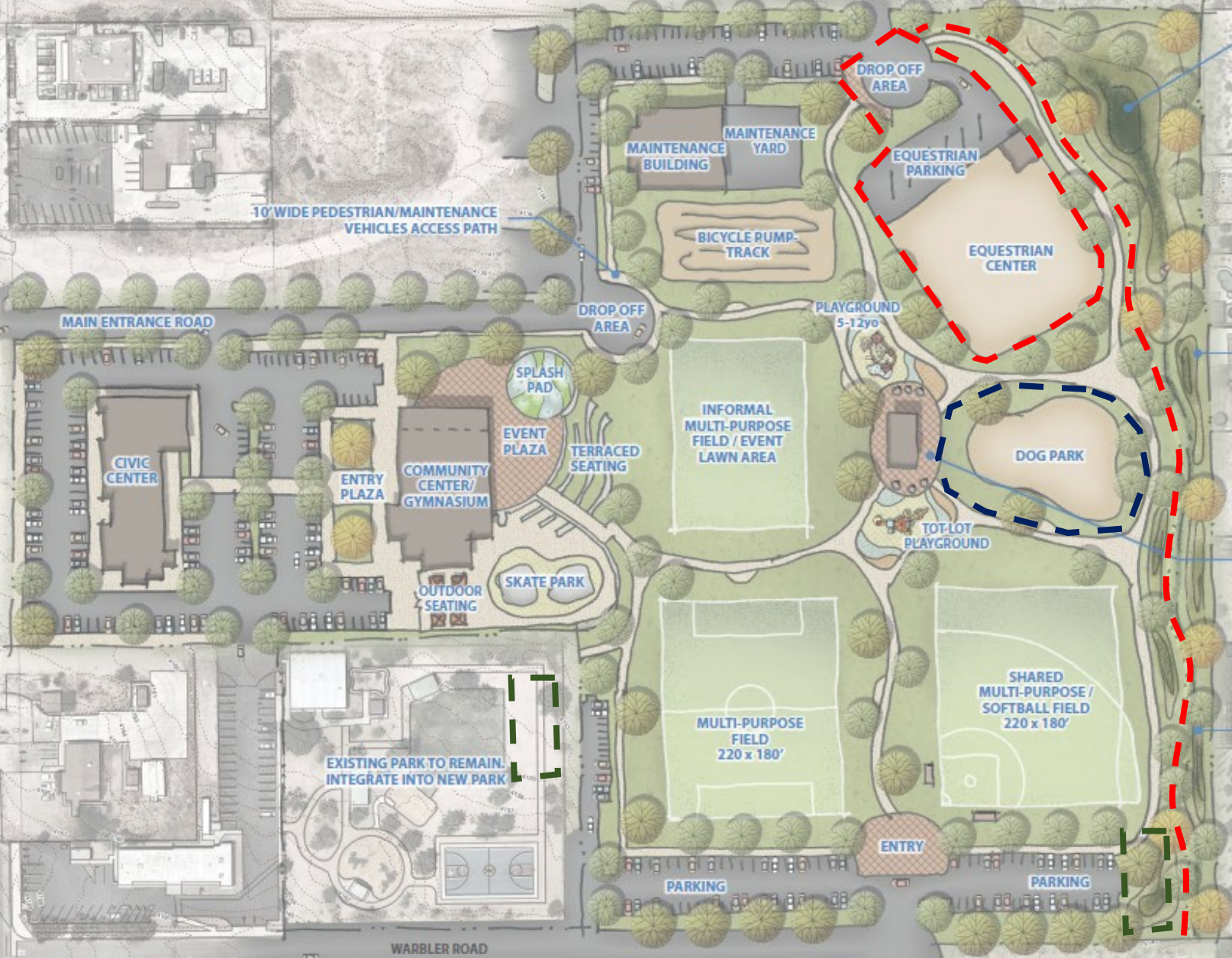

DETENTION BASIN/
NATURAL EDUCATION

10' WIDE PEDESTRIAN/MAINTENANCE
VEHICLES ACCESS PATH

MAIN ENTRANCE ROAD

DROP OFF AREA

DROP OFF AREA

MAINTENANCE
BUILDING

MAINTENANCE
YARD

BICYCLE PUMP
TRACK

EQUESTRIAN
PARKING

EQUESTRIAN
CENTER

SUNRISE BLVD

PLAYGROUND
5-12yo

BUFFER AREA WITH
TRAILS AND NATIVE
VEGETATION

SPLASH
PAD

EVENT
PLAZA

TERRACED
SEATING

INFORMAL
MULTI-PURPOSE
FIELD / EVENT
LAWN AREA

CIVIC
CENTER

ENTRY
PLAZA

COMMUNITY
CENTER/
GYMNASIUM

DOG PARK

CENTRAL PLAZA WITH
RESTROOM, CONCESSION

OUTDOOR
SEATING

SKATE PARK

TOT LOT
PLAYGROUND

STREAM COURSE FOR
FLOODWATER AND
DRAINAGE USING A DRY
CREEKBED

EXISTING PARK TO REMAIN,
INTEGRATE INTO NEW PARK

MULTI-PURPOSE
FIELD
220 x 180'

SHARED
MULTI-PURPOSE /
SOFTBALL FIELD
220 x 180'

ENTRY

PARKING

PARKING

WARBLER ROAD

2

EQUESTRIAN AREA AND TRAILS DISCUSSION



Area Overview

- Approx. 43K Sq. Ft.
- Located at northeast corner of site
- Includes equestrian parking area

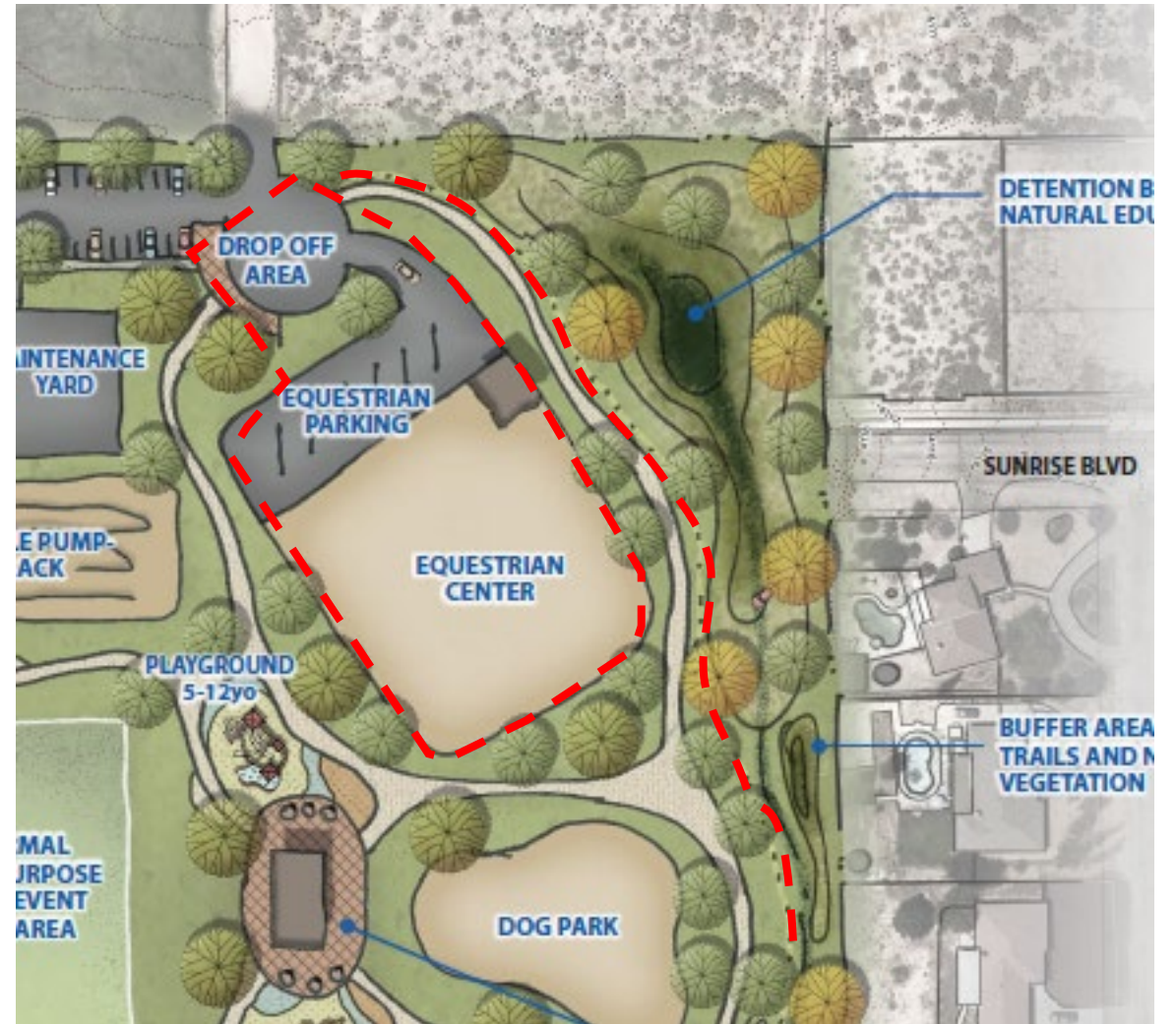



OUTDOOR RIDING ARENA



COVERED ARENA



TRAILS LEADING TO FACILITY



ROUND PENS & CORRALS



JUMPING FENCES



COVERED SEATING



PHELAN COMMUNITY PARK

EQUESTRIAN AREA OPTIONS

Questions

Please explain your experience with equestrian activities, interests, use levels or advocacy?

Questions

Would you say that there are large or very limited number of equestrian trails, riding facilities or special amenities in and around Phelan / Pinon Hills for equestrian users to take advantage of?

Questions

What are the closest riding areas to the park study area for riding trails?

Questions

Do you think there is a need to connect with local trails around the park that exist or could be made to exist?

Questions

Is the short riding distance (within a looped system of the park) even worth considering for equestrian uses or is the staging and loading / unloading not worth the effort? If the arena were there, is there any benefit to short walking / riding areas in support of the arena?

Questions

What specific equestrian uses would you see as part of the program. English Riding, Western Riding, Rodeo, Team Sports , Dressage, Jumping, Driving, Barrel Racing, Horsemanship, Polo or other?

Questions

How well do you feel these facilities would be used based on your understanding of demand?

Questions

What type of parking / staging area is essential?

Questions

What is the minimum size of the arena, pens, staging and parking area is needed?

Questions

How much are you willing to support the inclusion of this facility in this park and do you think there is a following that would support this?

A golden retriever is sitting on a green lawn, looking to the left with its tongue hanging out. A yellow tennis ball is on the grass in front of it. The background shows a line of trees under a clear sky.

3

DOG PARK AREA

Area Overview

- Approx. 13.5k Sq. Ft.
- Located centrally within the park towards the back eastern edge
- Existing Joshua tree location

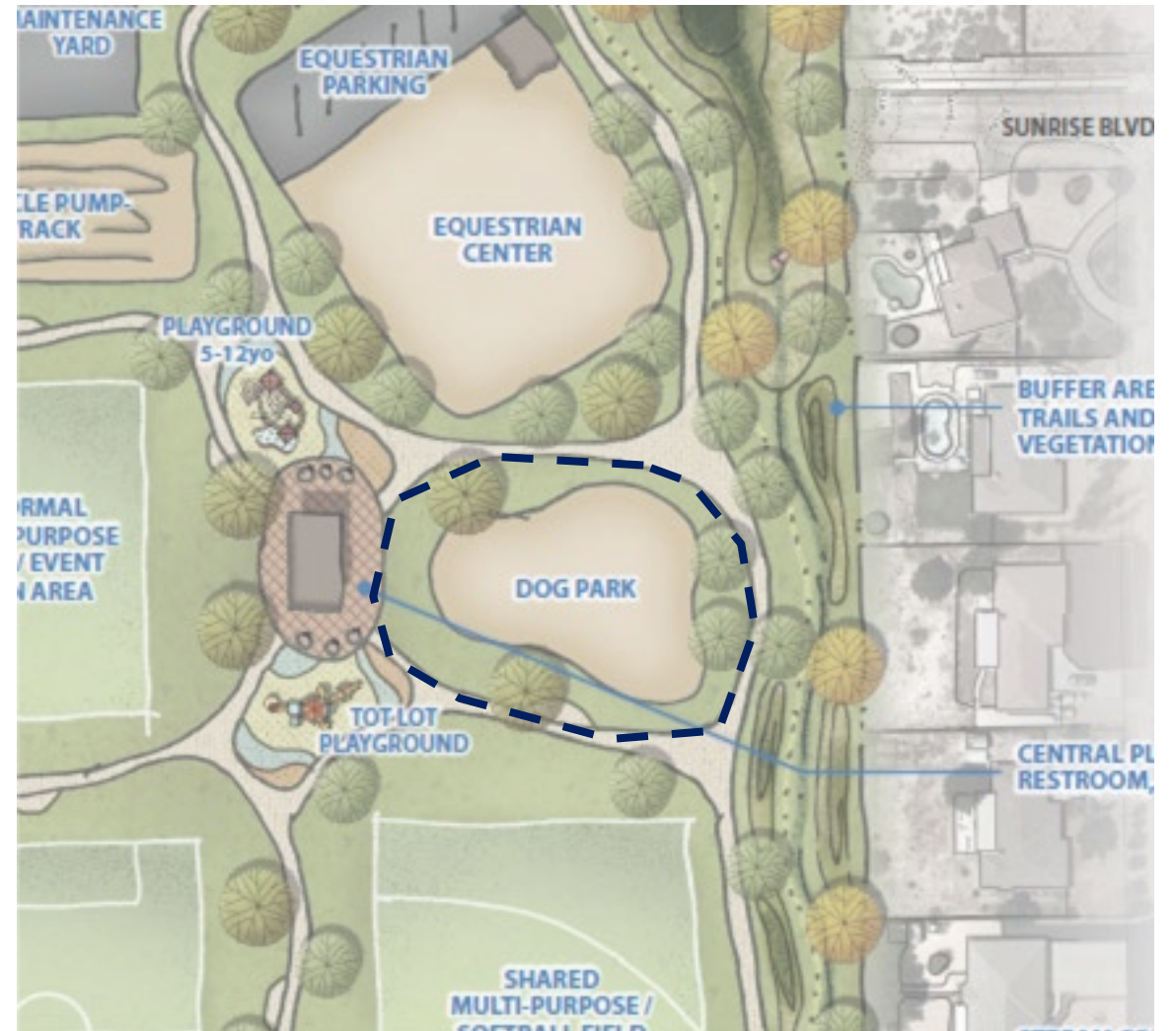



DOG PARK ELEMENTS

PHELAN COMMUNITY PARK

DOG PARK AREA OPTIONS

Questions

Do you currently walk your dog in any dog specific area around the community?

Questions

Should there be a fenced in / leash free dog use area in the park?

Questions

Should there be a non-fenced in leash free use allowed in the park at all?

Questions

What regulations on dog use in the park do you think would be acceptable to the general public?

Questions

What amenities are needed to help make the use of a dog leash free area feasible, safe, clean and comfortable?
Would a DG surface be acceptable? Or how important is turf?

Questions

Is there a need for both a small dog / big dog area, or to allow for more timed pets to be isolated from the more aggressive or expressive dogs?

Questions

Are there local groups that would provide maintenance and monitoring of the dog park, including minor repairs / renovation of areas by volunteers?

A photograph of a community garden with several raised wooden beds containing various plants. In the background, there is a building with a covered porch and a parking lot with cars. The image is overlaid with a semi-transparent dark layer.

4

COMMUNITY
GARDEN

Area Overview

- Approx. 3k Sq. Ft.
- 2 options that are being explored.
 - Near southeast corner of site near parking lot
 - Near existing park lawn

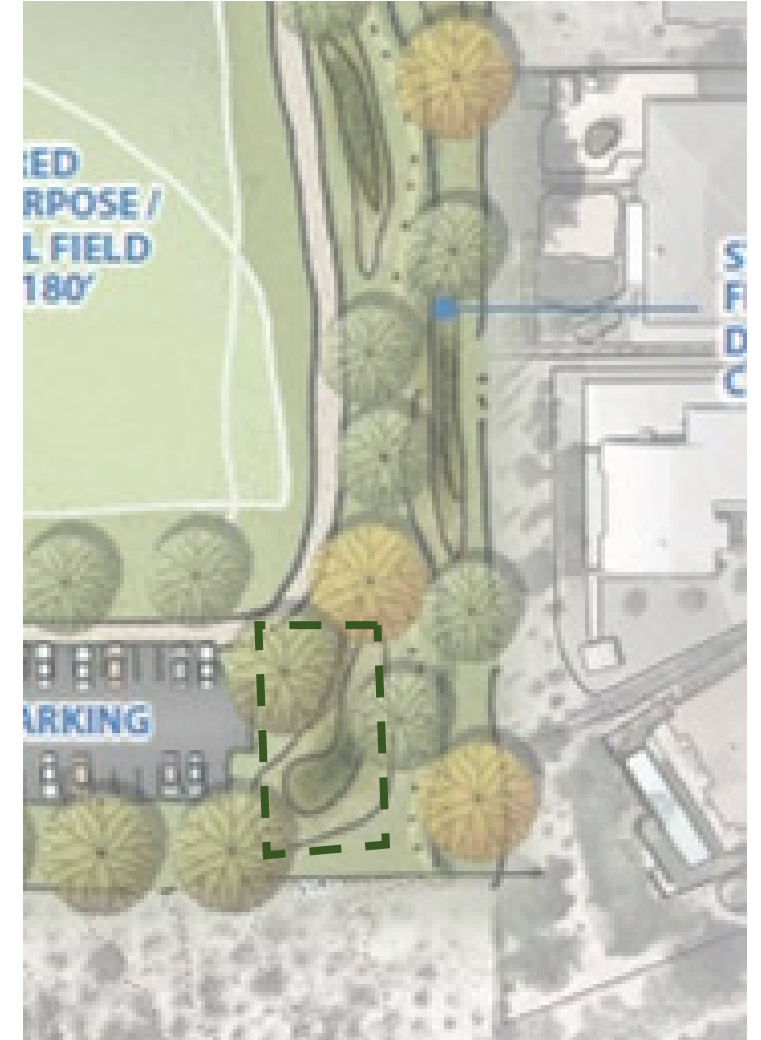
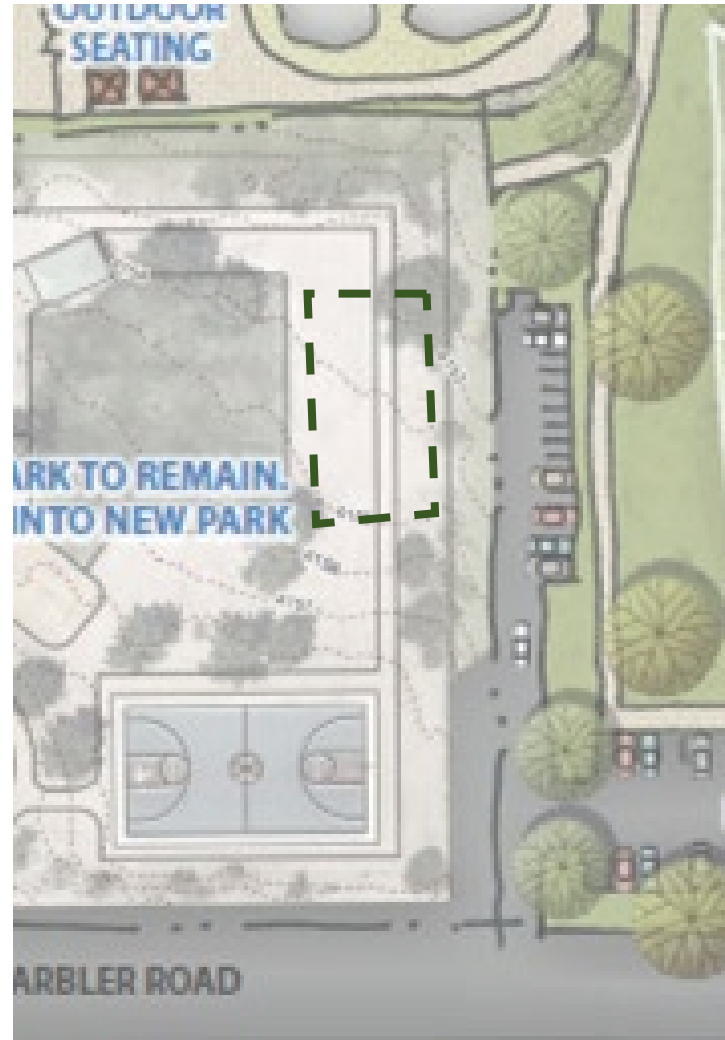



PHELAN COMMUNITY PARK

COMMUNITY GARDEN

Questions

Do you know of any community gardens, botanical gardens, native gardens in the valley area such as in Hesperia, Victorville, Apple Valley, etc.?

Questions

Are there any clubs that you know of that would support the running of a community garden? If not now, could they be formed?

Questions

How important would it be to you to preserve some portion of the native vegetation, including other native high desert plants, in part of the park?

Questions

Should trails through or around these areas only be natural surface (soil, decomposed granite, sand, gravel, etc.) or can they be asphalt or concrete as well? Is it worth doing colored concrete or exposed aggregate or other treatments to make these paths look more in context with the natural surroundings?

Questions

How important should it be to have ADA access through all of these trail areas, or just some portion of it?

Questions

Is it better to have some of the main loops of walkways running through the park, come through these potential gardens, or should they be separate from these garden areas?

Questions

Would a community garden be maintained by the community, is there enough of a volunteer base to make this happen?

Questions

Would it be acceptable to have a botanical garden that included other plants than just those found in the immediate local habitat of the high desert, but that are native to California at least?





5

**CLOSING REMARKS
AND GENERAL
DISCUSSION**

Online Survey

2. Adventure Sports

Please indicate your priority, however, please do not select the same priority for all.

	Low	Medium	High
Pump Track (bmx / mtn. bike circular track) 	<input type="radio"/>	<input type="radio"/>	<input type="radio"/>
Skatepark 	<input type="radio"/>	<input type="radio"/>	<input type="radio"/>
Playground 2-5 years old 	<input type="radio"/>	<input type="radio"/>	<input type="radio"/>
Playground 5-12 years old 	<input type="radio"/>	<input type="radio"/>	<input type="radio"/>

Next Steps – Team Schedule

- Community Workshop #1
- Community Stakeholder Meetings
- Community Workshop #2
 - Final Program Summary
 - Pre-Final Site Plan
 - Area Enlargements
- Community Workshop #3
 - Final Materials & Amenities
 - Cost Prioritization & Phasing
 - Prop 68 Areas / Facilities
- Community Workshop #4 / Board Hearing

PROJECT SCHEDULE		AUG				SEP				OCT				NOV				DEC				JAN		FEB		
PHELAN COMMUNITY PARK SCHEMATIC DESIGN		10	17	24	31	7	14	21	28	5	12	19	26	2	9	16	23	30	7	14	21	28				
UPDATED - 08/11/2020		2020																				2021				
AREA A: 14-ACRE PARK																										
TASK GROUP A: KICK-OFF & COMMUNITY OUTREACH																										
1.1 Kick Off Meeting																										
1.2A Digital Community Workshop #1																										
1.2B Digital Community Workshop #2																										
1.3A Stakeholder Interest Group Meeting #1																										
1.3B Stakeholder Interest Group Meeting #2																										
1.3C Stakeholder Interest Group Meeting #3																										
TASK GROUP B: DRAFT SCHEMATIC DESIGN PACKAGE (15%)																										
1.4 Final Programming																										
1.5-1.11 Schematic Design 14 Acre Park																										
1.12 Draft Package for Initial CUP Conformance																										
1.13 Draft Construction Estimate (with 25% contingency)																										
1.14: 3D Model & Perspectives (4 total)																										
TASK GROUP D: REFINED MASTER PLAN & WORKSHOPS #3 & 4																										
2.1 Refined Master Plan																										
2.2A Digital Community Workshop #3																										
2.2B Digital Community Workshop #4 / Board Hearing																										
TASK GROUP E: FINAL SCHEMATIC PACKAGE (35%)																										
2.3 - 2.11: Final Schematic Design, 14 Acre Park																										
2.12: Construction Estimate (with 25% contingency)																										
2.13: Outline Specifications																										
2.14: CD Sheet / Package Layout & Numbering																										
2.15: Revised 3D Model and Perspectives (4 total)																										
TASK GROUP F: FINAL CUP PACKAGE																										
2.16: CUP Package for 14-acre park (architect to process)																										

Questions & Comments